

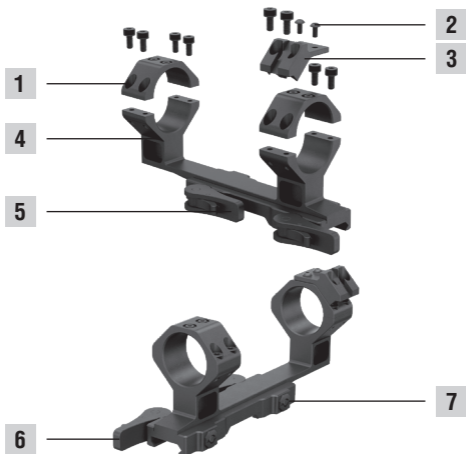

HIGH PROFILE QUICK DETACH HEAVY DUTY MOUNT

MANUAL



DESCRIPTION

The High Profile Quick Detach Mount (HPQDM) is designed specifically to be used with the X-Sight 4K, ThOR 4 and ThOR 5 320/640/XD Series of scopes. The HPQDM allows you to quickly switch your scope between rifles; allowing you to take full advantage of the 6 different profiles you can utilize in your Smart HD scope. Simple to install and use, the quick detach mount provides a way for you to swap weapons easily, all while retaining zero.

INSTALLATION GUIDE

CAUTION

Before placing the HPQDM mount on your weapon, make sure it is unloaded and safe to handle.

Place the HPQDM on a level surface. Loosen the Allen screws that hold the upper portion of the rings (1) with the provided Allen wrench. Place your scope onto the bottom portion of the rings. Make sure your scope is level. Place the top portion of the rings back over the lower half, making sure the holes are aligned. Use equal torque to tighten down the Allen screws. Use 13lb-inch of torque to set the rings in place.

Depress lever lock and flip quick detach levers (5) and (6) into the unlocked position. Place HPQDM on your platform, making sure the mount sits flush on the rail and the mount is pushed forward in the rail slot. Attempt to engage quick detach levers into the locked position. Do not apply excessive pressure to the levers to accomplish this. If levers will not lock with reasonable pressure applied, or if very little pressure is required to lock quick detach levers, allowing the mount to move on the rail, adjustment to tension is required.

To adjust tension, the levers must be in the unlocked and open position. Apply lateral pressure to the levers, pushing toward the opposite side of the mount. The hex nuts (7), on the side of the mount, rise from the milled hex pocket in the mount when lateral pressure is applied, and rotate to adjust tension. If more tension on the rail is required to prevent forward or aft movement, rotate the hex nut clockwise. If less tension on the rail is required allowing for engagement of levers, rotate the hex nut counterclockwise. Attempt to engage quick detach levers into the locked position to test tension setting. Tension is properly adjusted when the quick detach levers can be engaged in the locked position with firm pressure and the mount cannot be moved forward or aft on the rail. Engage and disengage the quick detach levers several times to test adjustment and guarantee there is NO movement of the mount on the rail when engaged. Perform this test each time you remount the HPQDM.

Ensure the mount allows for proper eye relief on the platform. Follow the zero procedure from your scope manual to achieve zero of the scope to your rifle.

American Technologies Network Corp.

2400 NW 95 Ave, Doral, FL 33172
phone: 800-910-2862, 650-989-5100
e-mail: service@atncorp.com
www.atncorp.com

©2022 ATN Corporation